

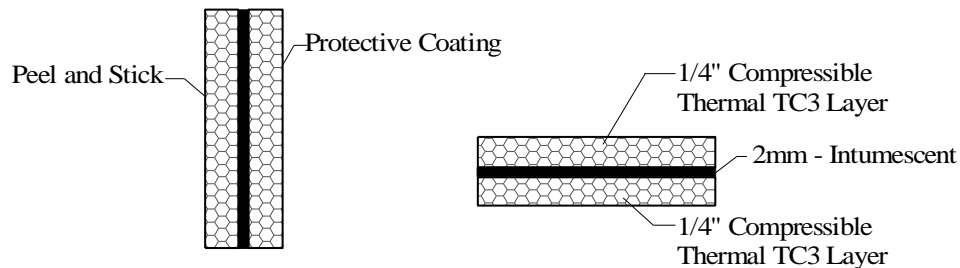

Resilient Channel Gasket – “RCG”

- “Peel & Stick” Resilient Channel Gasket - Install Before Stud & Drywall
- Seal RC Buildup or “Chimney Gap” in Rated Dynamic & Static Partitions
- 100% Unencumbered Movement up to **1.50”** Overall Deflection Capability
- Third Party STC (ASTM E-90) & Fire/Smoke (UL 2079 v.5) - [HW-D-0890](#)
 - **Temp: Storage & Application: - 10 to 150 °F**

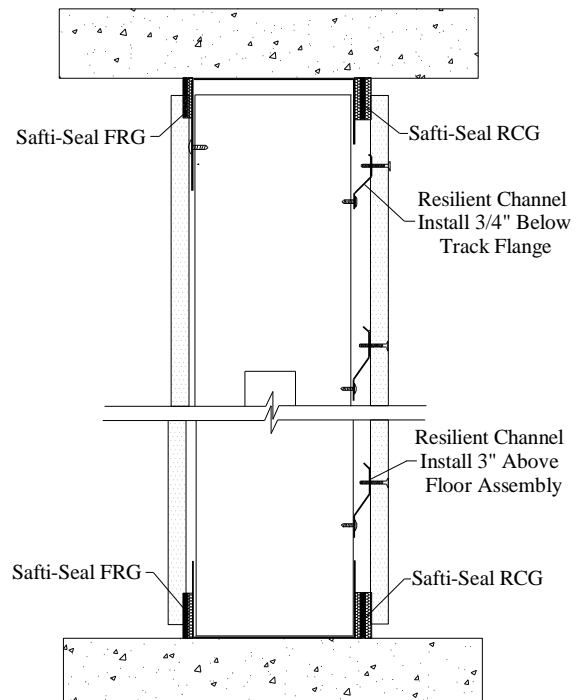

Product	Box Size	Strip Width	Length	Pcs/Box	Lft/Box	Install Gap	Max Deflection
RCG-75	10 x 10 x 48”	1.00”	4’	170	680	0.375”	0.75”
RCG-100	10 x 10 x 48”	1.25”	4’	135	540	.50”	1.00”
RCG-150	10 x 10 x 48”	1.75”	4’	95	380	.75”	1.50”



Product Profile Dimensions – Submittal

Avoid Non-Certified System & STC Issues:

- ½” Thick Drywall Fill (Non-Rated)
- Foam Sleeve with “Chimney Gap”
- Caulk or Sealant “Balancing Act”
- Vinyl Trims with “Chimney Gap”
- Unsupported & Gap Behind Issues

