

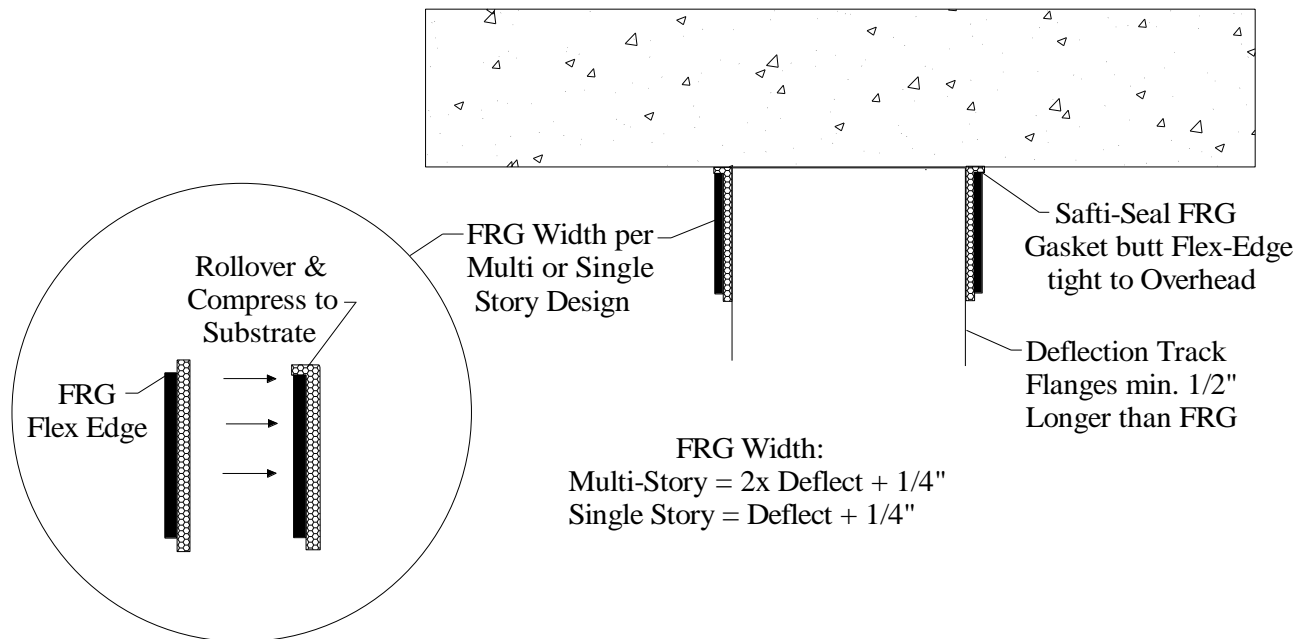

Install Guide & Tips – Inspection & Verification of Deflection

Installation Guide and Tips – Inspection & Verification



Inspection Before Stud, MEP, & Gypsum Install

- 1) FRG cured gasket - No Destructive Inspection - Install per UL HW-D, BW-S, or WW-S series design in UL Fire Resistance Directory (iq.ulprospector.com - Joint Systems - (Keyword) "FRG") or click blue highlighted link from Safti-Seal "Plan Set Details"
- 2) Width of FRG install and to measure/verify is based on structural deflection specified:
 - Multi-Story = $2x \text{ Deflection} + 1/4"$
 - Single-Story = $\text{Deflection} + 1/4"$
- 3) Track Flange to be min. 1/2" longer than FRG Gasket
- 4) Upon inspection verify NO "daylight" above or through FRG (butt joints) with observed "blacked out" install - fire, smoke, and sound seal is in place. Any small embossments (metal deck) or gaps (concrete build up, pitting, or spalling above FRG) a dab of mineral wool or sealant can be used to fill for ambient air seal.
- 5) No curing, shrinkage, deflection degradation or maintenance for life of assembly

Entire assembly construction and linked UL certifications can be found at www.saftiseal.com under "Details/Submittals - Plan Set Details" drill down or www.ul.com



Install Guide & Tips – Inspection & Verification of Deflection

Installation Guide and Tips – Inspection & Verification

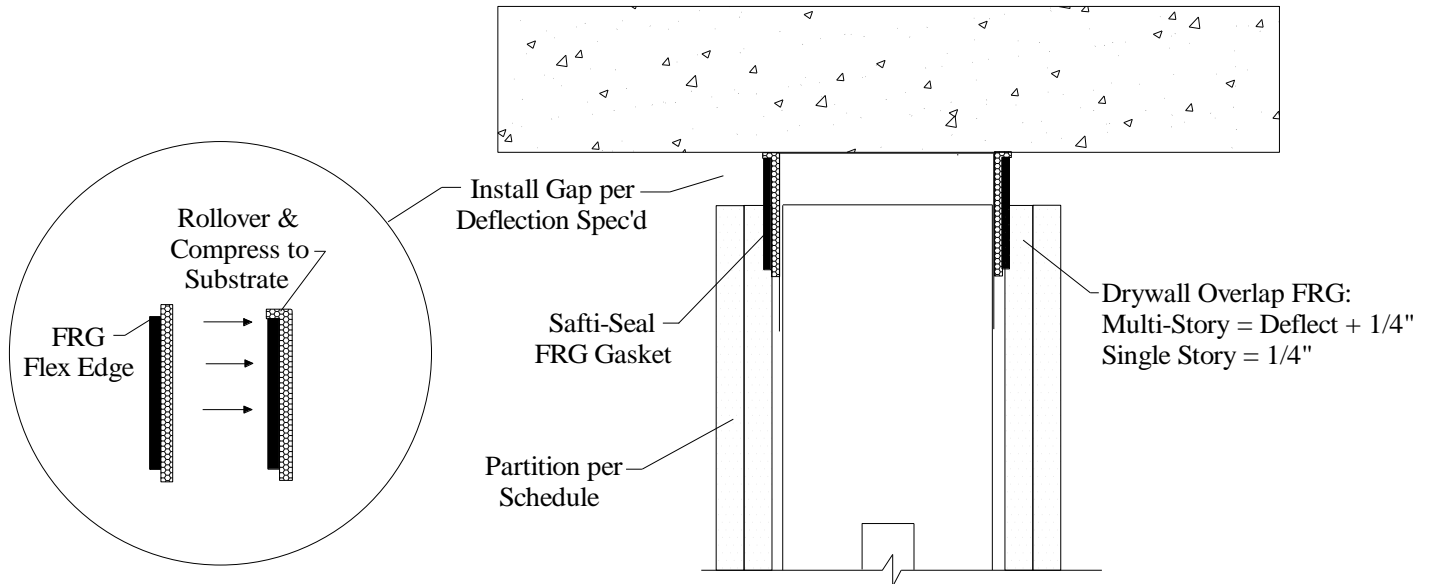

Inspection After Stud, MEP, & Gypsum Install

- 1) FRG cured gasket - ***No Destructive Inspection*** - Installed per UL HW-D, BW-S, or WW-S series design in UL Fire Resistance Directory (iq.ulprospector.com - Joint Systems - (Keyword) "FRG") or click blue highlighted link from Safti-Seal "Plan Set Details"
- 2) Width of Drywall Install Gap to measure/verify is based on structural deflection & 100% movement certification:
 - Multi-Story = Specified Deflection
 - Single-Story = Specified Deflection
- 3) Upon inspection verify ***NO*** "daylight" above or through FRG (butt joints) with observed "blacked out" install - fire, smoke, and sound seal is complete. Any small embossments (metal deck) or gaps (concrete build up, pitting, or spalling above FRG) a dab of mineral wool or sealant can be used to fill for ambient air
- 4) No curing, shrinkage, deflection degradation or maintenance for life of assembly

Entire assembly construction and linked UL certifications can be found at www.saftiseal.com under "Details/Submittals - Plan Set Details" drill down or www.ul.com