

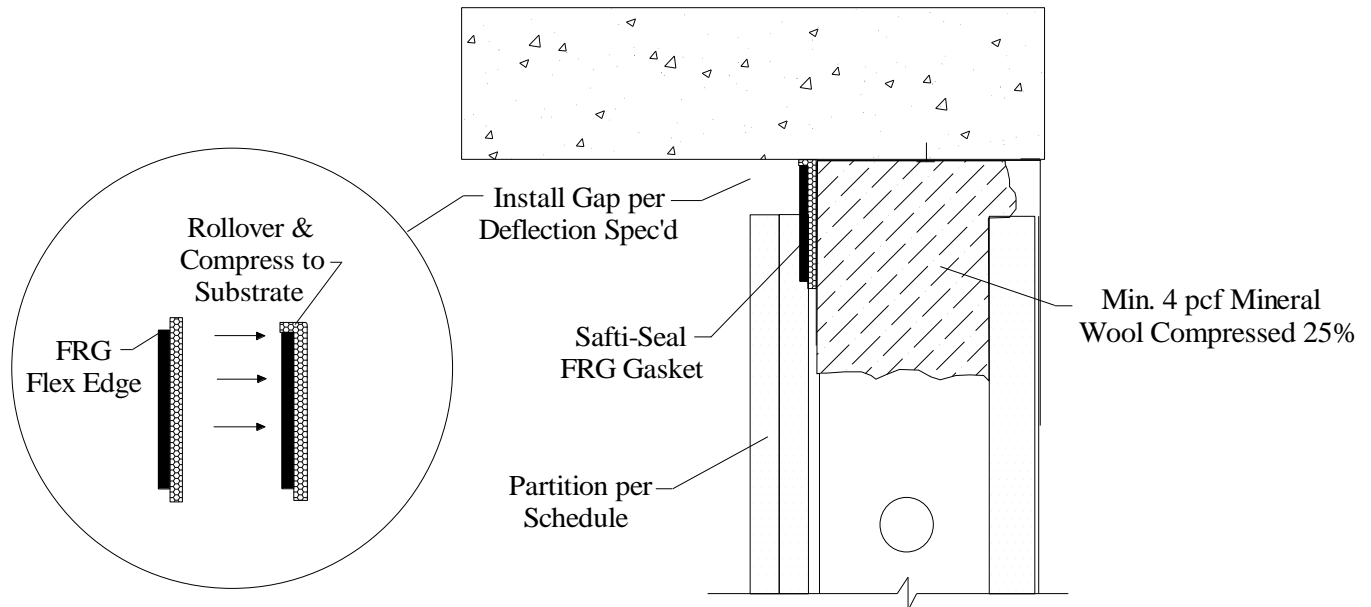

Install Guide & Tips – “Dynamic” Shaft Wall Deflection

Installation Guide and Tips – Shaft Wall under Flat PT/Slab



- 1) Shaft Wall Assembly – Install per UL U, V, or W400 series design in UL Fire Resistance Directory
- 2) Safti-Seal – Roll “Flex-Lock” edge of FRG onto substrate with firm and continuous contact supporting with rigid intumescent portion of gasket. Install width of FRG to accommodate designed deflection requirements maintaining a min. 1/4” overlap in “open” position
- 3) Compress min. 4 pcf Mineral Wool a min. 25% insert and fill track cavity
- 4) Deflection Gap – Deflection gap install per design requirements according to UL listed assembly to accommodate Engineered and Specified Deflection Requirements

Assembly construction and UL certification listing can be found at www.saftiseal.com or www.ul.com
Listed assembly: [HW-D-0889](#) (Shaft Wall) or [HW-D-0898](#) (Shaft Wall – Fluted Deck)