

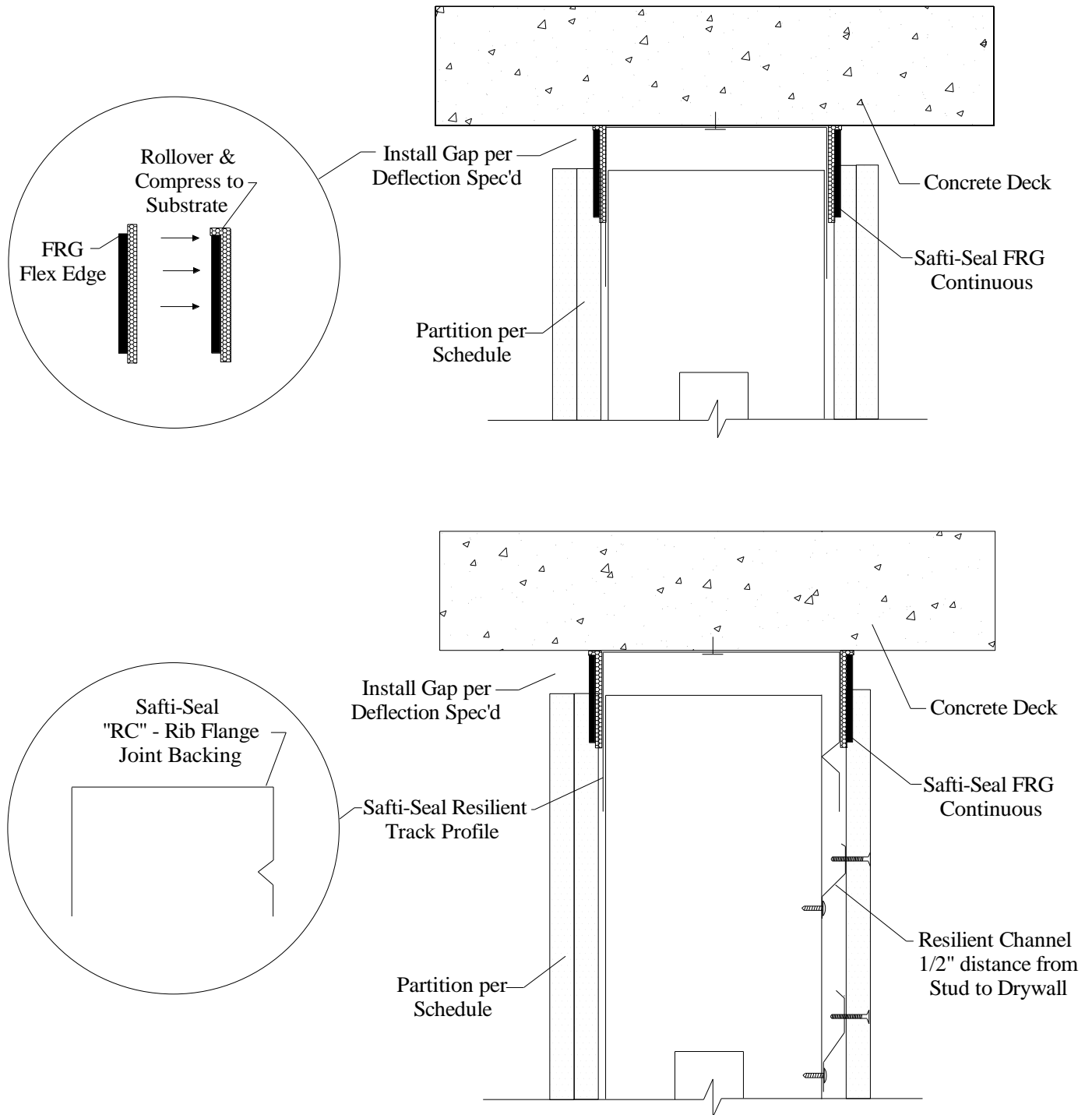

Install Guide & Tips – FRG Flex-Lock to Flat Concrete Substrate

Install Guide – FRG Flex-Lock – Single & RC Track Wall Flat PT/Slab





Install Guide & Tips – FRG Flex-Lock to Flat Concrete Substrate

Install Guide – FRG Flex-Lock – RC Gasket & Chase Wall Flat PT/Slab

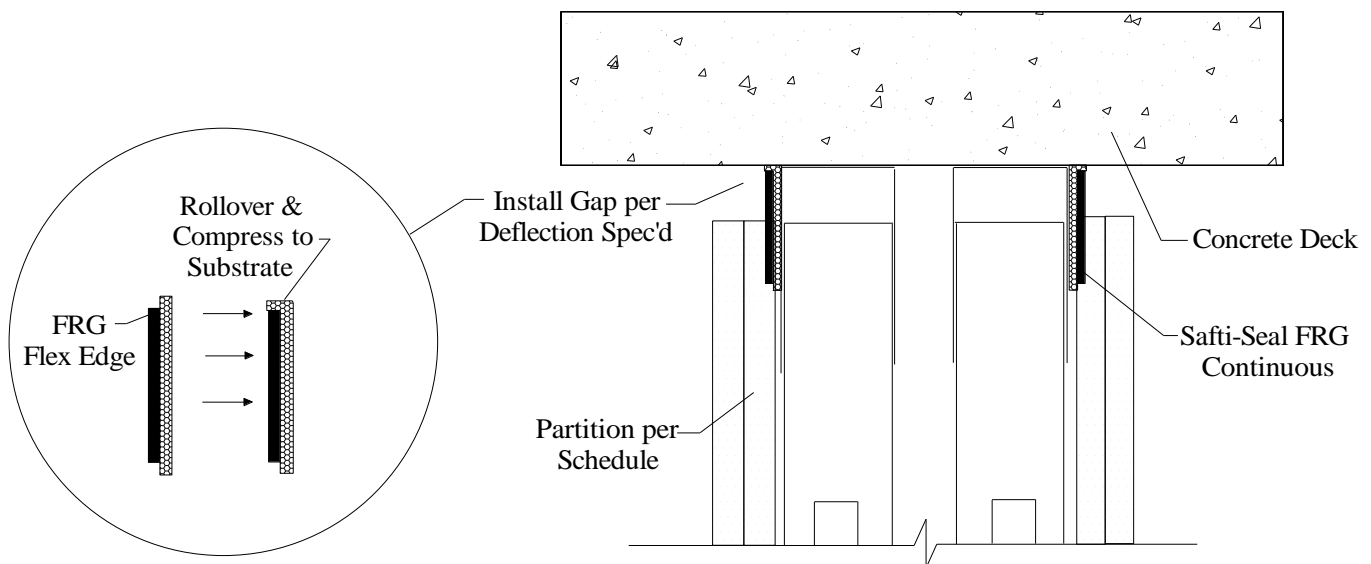
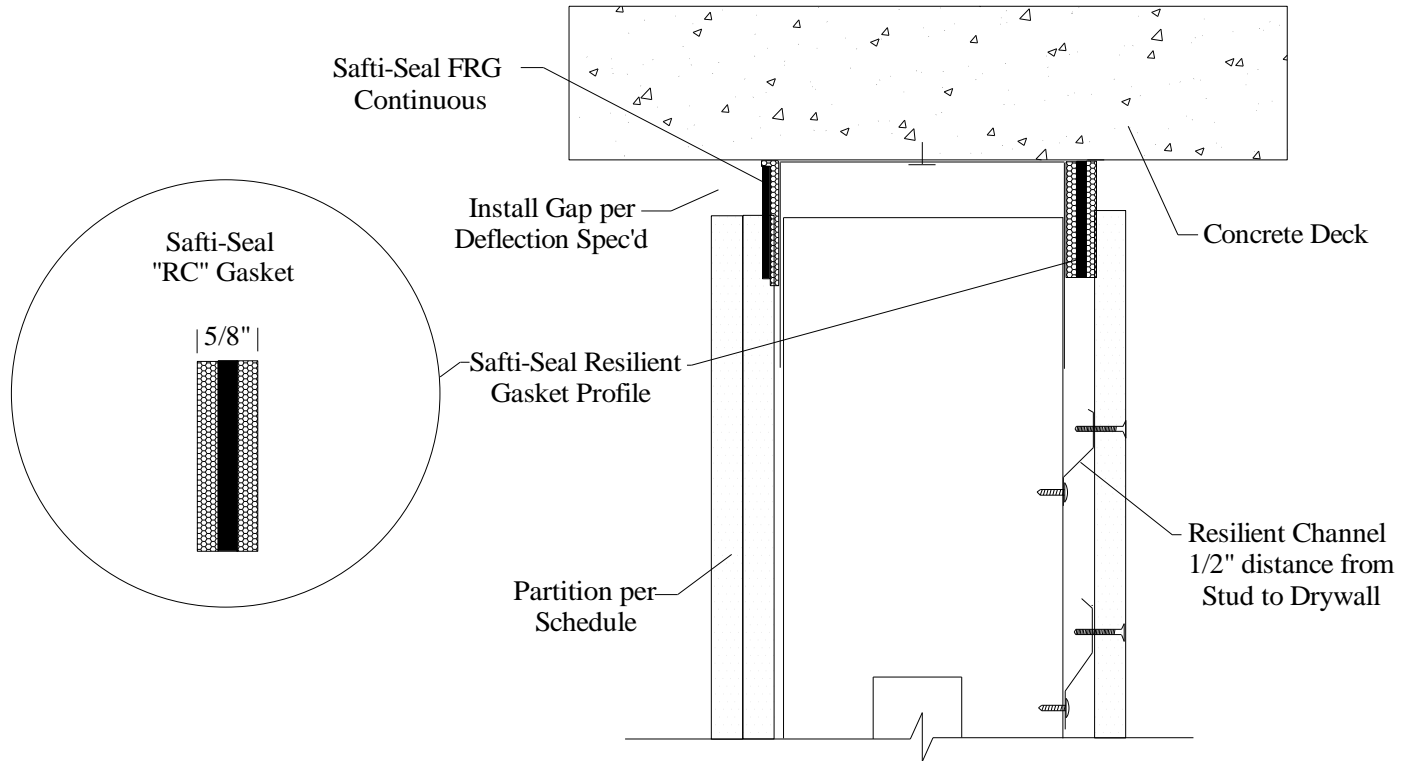



Install Guide & Tips – FRG Flex-Lock to Flat Concrete Substrate

Install Guide – FRG Flex-Lock – Code Compliant Gap Repair PT/Slab

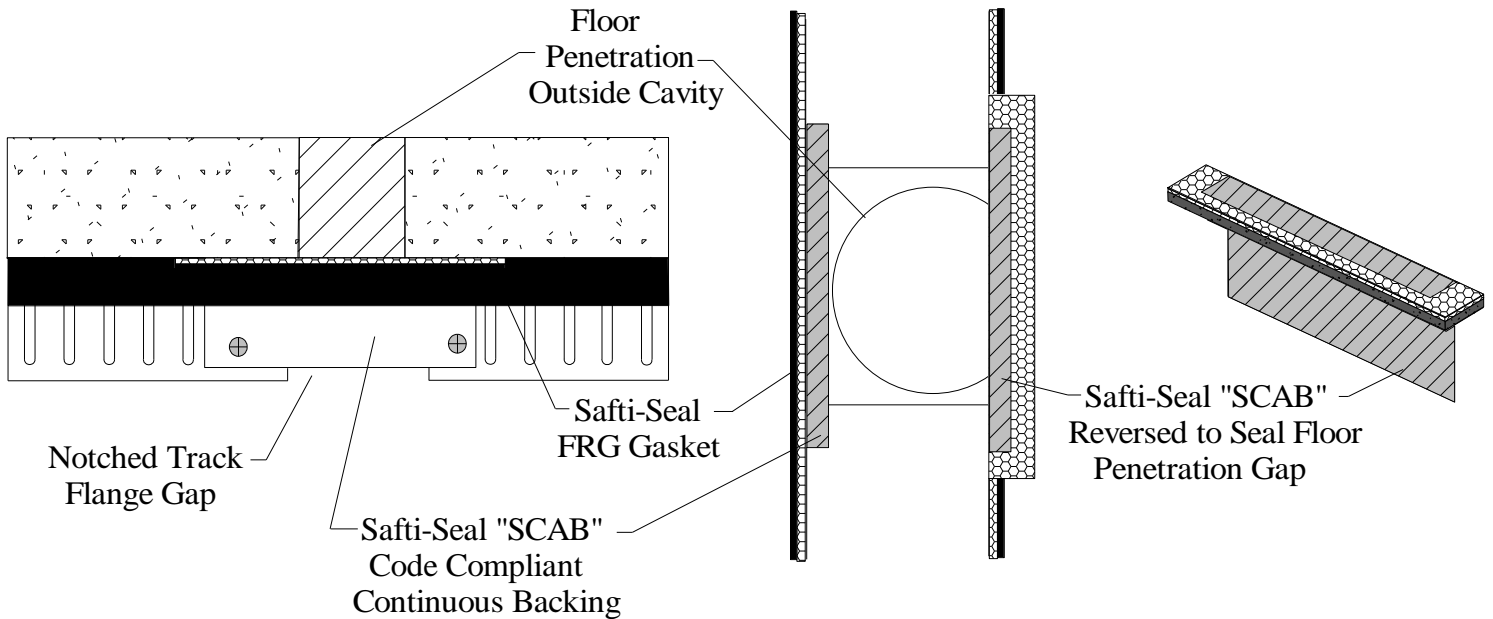
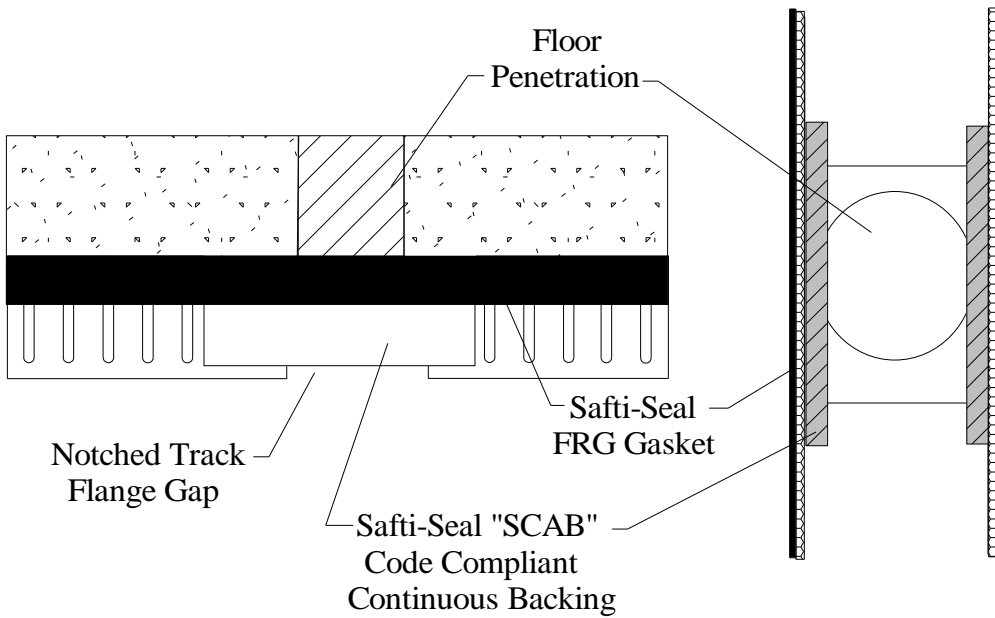



Install Guide & Tips – FRG Flex-Lock to Flat Concrete Substrate

Install Guide – FRG Flex-Lock – Apply to Wall Assemblies Flat PT/Slab

- 1) Single, Chase, or Resilient Channel Wall Assembly – Install per UL U, V, or W400 series design in UL Fire Resistance Directory
- 2) Safti-Seal – Roll “Flex-Lock” edge of FRG onto substrate with firm and continuous contact supporting with rigid intumescent portion of gasket. Install width of FRG to accommodate designed deflection requirements maintaining a min. 1/4” overlap in “open” position
- 3) Deflection Gap – Deflection gap install per design requirements according to UL listed assembly to accommodate Engineered and Specified Deflection Requirements

Assembly construction and UL certification listing can be found at www.saftiseal.com or www.ul.com
 Listed assembly: [HW-D-0890](#) (Single, RC Wall & Repair) or [HW-D-0892](#) (Chase Wall)

Field application of Safti-Strip FRG (roll material):

- a) Verify track flange surface is oil and dirt free and continuous backing is provided for support of joint material protection
- b) Peel and stick Safti-Seal FRG (Flex-Lock Edge rolled onto substrate) applying pressure upward to create firm contact with overhead substrate and then inward pressure to engage pressure sensitive adhesive
- c) Apply gasket continuous adjoining butt ends firmly in contact with each other overlapping flange repairs, wrapping corners, and firmly abut dissimilar materials
- d) Use strip width to accommodate designed deflection per Safti-Seal chart reference

Product	Strip Width	Length	Max. Joint	Solid Leg	Slotted Leg	Slotted Leg	Slot Location
		Lft/Roll	Protection	Profile	Profile	Slot Length	Below Web
FRG-75	1.00”	82’	.75”	2.00”	2.50”	1.50”	.50”
FRG-100	1.25”	82’	1.00”	2.00”	3.00”	1.50”	1.00”
FRG-150	1.75”	82’	1.50”	2.50”	4.00”	2.00”	1.50”
FRG-200	2.25”	82’	2.00”	3.00”	N/A	N/A	N/A

- e) Dissimilar materials in contact with Safti-Seal FRG to be Non-Solvent based
- f) Gypsum installed overlapping FRG only per UL listed assembly and deflection condition
- g) Small construction or substrate voids occurring above track/Safti-Seal FRG joint protection fill with UL classified caulk – should be no daylight pass through either above or through Safti-Seal FRG joint protection