

# Flat Concrete Substrate



## PT11 – Vertical Wall to Wall Gypsum to Concrete Column

**Deflection Joint Protection** - Strip / Framing Series refer to UL Listing: [WW-S-0055](#)

.75" - 100 / Stock      1.00" - 125 / "W"      1.50" - 175 / "X"      2.00" - 225 / "Z"

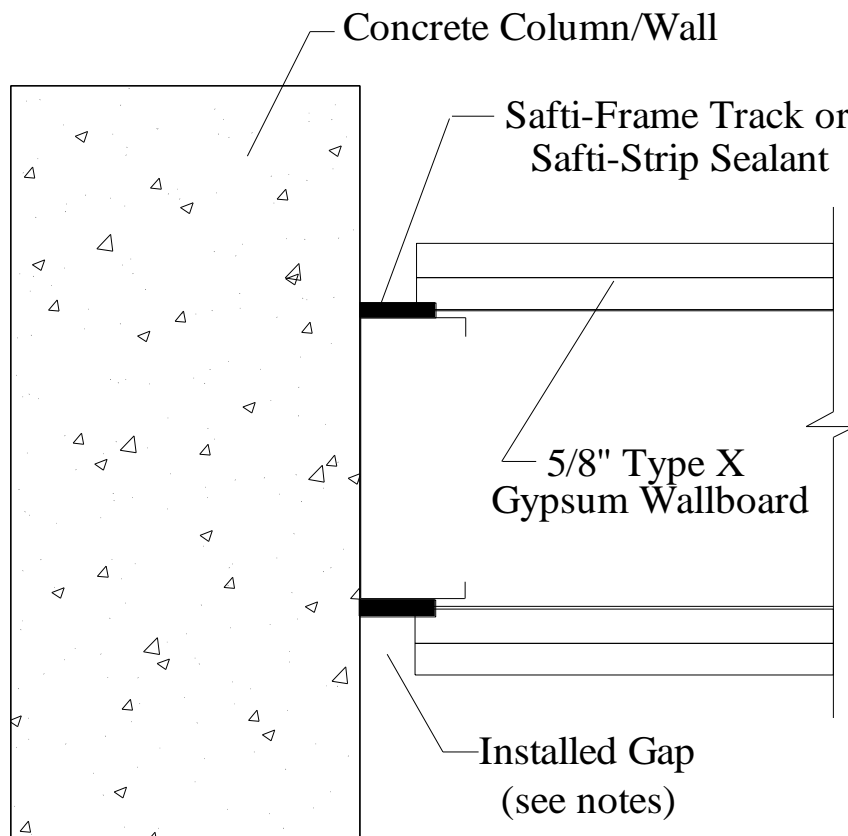

1. Installed Gap = **Deflection Joint Protection**
2. Attach to substrate with approved fastener max 24" O/C or per E.O.R.
3. Attach drywall to stud or SaftiFrame profile with typical steel fasteners
4. Drywall fasteners installed per U, V, or W400 series UL design

### UL, ASTM & Code Standards

UL2079 (5<sup>th</sup> Edition) & CAN/ULC S115  
ASTM E814, E1966, E2837  
A1003, A653, A924, C645, C754, C955  
Sound Tested according to ASTM E90-09  
2012 & 2015 IBC

### Leed Points

MR 2.1 & 2.2 - Construction Waste: up to 2pts  
MR 4.1 & 4.2 - Recycled Content: up to 2 pts  
MR 5.1 & 5.2 - Regional Proximity  
EQ 4.1 - Low Emitting Materials  
EQ 9 - Enhanced Acoustical

Phone: (425) 869-2811 Fax: (425) 869-2300

[www.saftiseal.com](http://www.saftiseal.com)