

# Unprotected "Bare" Fluted Substrate



## UD6 - Centered Under Flute - Flute Cover Only

**Deflection Joint Protection** - Strip / Framing Series refer to UL Listing: [HW-D-0544](#)

.75" - 100 / Stock    1.00" - 125 / "W"    1.50" - 175 / "X"    2.00" - 225 / "Z"

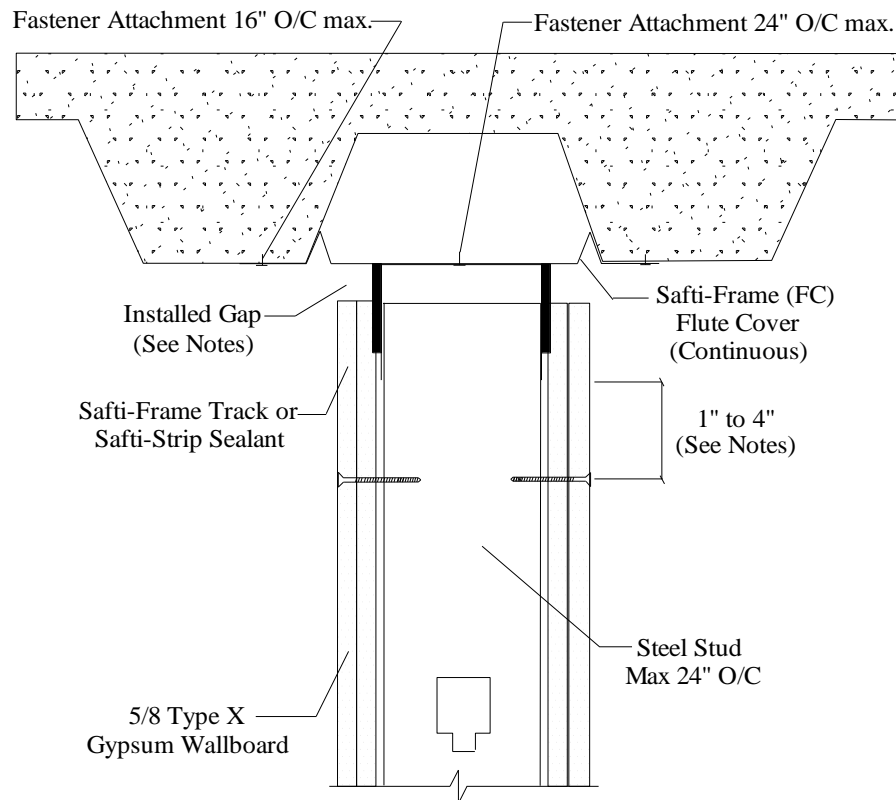

1. Installed Gap - Single Story (compression only) = **Deflection Joint Protection**
2. Installed Gap - Multi-Story (compress + extension) = **1/2 distance** of **Deflection Joint Protection**
3. Attach to substrate with approved fastener max 24" O.C or per E.O.R.
4. Do not screw drywall or stud to BlazeFrame solid leg profile studs "free float"
5. "Slotted" profile metal framing fastener installed center of slot (min. one side)
6. Drywall fasteners 1" to 4" below SaftiFrame to accommodate movement
7. Install min 3" width 4pcf mineral wool comp. 33% above flute cover when "open or butted" end(s)

### UL, ASTM & Code Standards

UL2079 (5<sup>th</sup> Edition) & CAN/ULC S115  
 ASTM E814, E1966, E2837  
 A1003, A653, A924, C645, C754, C955  
 Sound Tested according to ASTM E90-09  
 2012 & 2015 IBC

### Leed Points

MR 2.1 & 2.2 - Construction Waste: up to 2pts  
 MR 4.1 & 4.2 - Recycled Content: up to 2 pts  
 MR 5.1 & 5.2 - Regional Proximity  
 EQ 4.1 - Low Emitting Materials  
 EQ 9 - Enhanced Acoustical

Phone: (425) 869-2811    Fax: (425) 869-2300