

# Unprotected "Bare" Fluted Substrate



## UD7 - Offset Valley - Flute Cover Only

**Deflection Joint Protection** - Strip / Framing Series design based on UL Listing: [HW-D-0544](#)

**.75"** - 100 / Stock      **1.00"** - 125 / "W"      **1.50"** - 175 / "X"      **2.00"** - 225 / "Z"

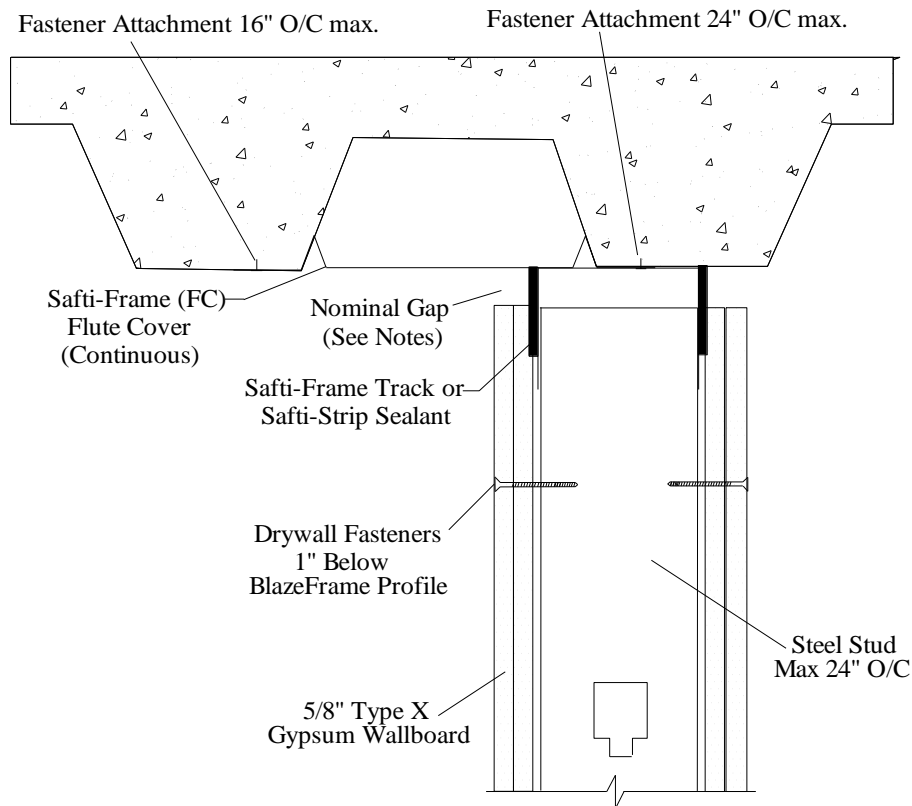

1. Installed Gap - Single Story (compression only) = **Deflection Joint Protection**
2. Installed Gap - Multi-Story (compress + extension) = **1/2 distance** of **Deflection Joint Protection**
3. Attach to substrate with approved fastener max 24" O.C or per E.O.R.
4. Do not screw drywall or stud to BlazeFrame solid leg profile studs "free float"
5. "Slotted" profile metal framing fastener installed center of slot (min. one side)
6. Drywall fasteners 1" to 4" below SaftiFrame to accommodate movement
7. Install min 3" width 4pcf mineral wool comp. 33% above flute cover when "open or butted" end(s)

### UL, ASTM & Code Standards

UL2079 (5<sup>th</sup> Edition) & CAN/ULC S115  
ASTM E814, E1966, E2837  
A1003, A653, A924, C645, C754, C955  
Sound Tested according to ASTM E90-09  
2012 & 2015 IBC

### Lead Points

MR 2.1 & 2.2 - Construction Waste: up to 2pts  
MR 4.1 & 4.2 - Recycled Content: up to 2 pts  
MR 5.1 & 5.2 - Regional Proximity  
EQ 4.1 - Low Emitting Materials  
EQ 9 - Enhanced Acoustical

Phone: (425) 869-2811 Fax: (425) 869-2300