

Vertical & Miscellaneous



VM11 - Sound Wall Resilient Channel – Head of Wall

Deflection Joint Protection - Strip / Framing Series refer to UL Listing: [HW-D-0498](#)

.75" - 100 / Stock 1.00" - 125 / "W" 1.50" - 175 / "X" 2.00" - 225 / "Z"

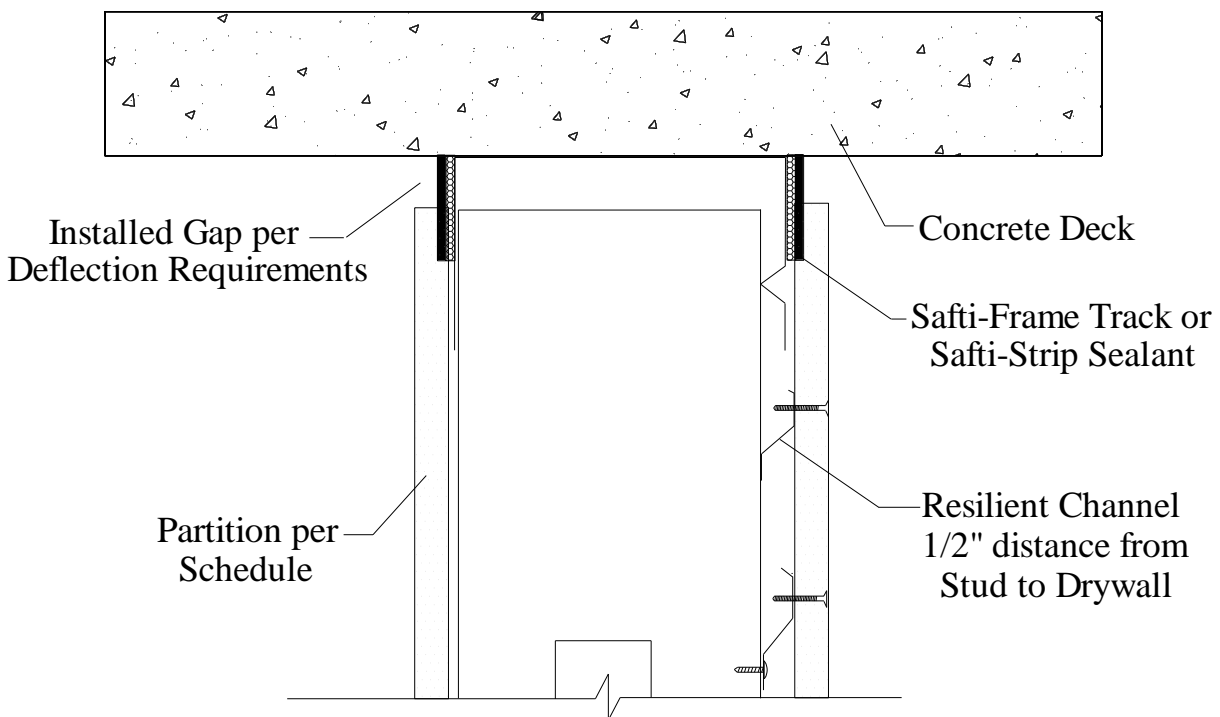

1. Installed Gap - Single Story (compression only) = *Deflection Joint Protection*
2. Installed Gap - Multi-Story (compress + extension) = 1/2 distance of *Deflection Joint Protection*
3. Attach to substrate with approved fastener max 24" O.C or per E.O.R.
4. Do not screw drywall or stud to Safti-Frame solid leg profile studs "free float"
5. "Slotted" profile metal framing fastener installed center of slot (min. one side)
6. Drywall fasteners 1" to 4" below Safti-Frame to accommodate movement
7. Attach gypsum to resilient channel only (where exists)

UL, ASTM & Code Standards

UL2079 (5th Edition) & CAN/ULC S115
ASTM E814, E1966, E2837
A1003, A653, A924, C645, C754, C955
Sound Tested according to ASTM E90-09
2012 & 2015 IBC

Leed Points

MR 2.1 & 2.2 - Construction Waste: up to 2pts
MR 4.1 & 4.2 - Recycled Content: up to 2 pts
MR 5.1 & 5.2 - Regional Proximity
EQ 4.1 - Low Emitting Materials
EQ 9 - Enhanced Acoustical

Phone: (425) 869-2811 Fax: (425) 869-2300

Vertical & Miscellaneous
